

3. REMOVING ABS SYSTEM

4.1. WITH STANDARD BRAKE SYSTEM (ABS)

Regardless of the type of ECU (standard or Marelli Racing) and instrument cluster used, the ABS system may be disabled by following the relative procedure indicated in the motorcycle user manual.

4.2. WITH RACING BRAKE SYSTEM AND ABS ECU

Even using a simplified braking system, fitting separate front and rear brake lines, it is still necessary to keep the ABS ECU installed on the vehicle and connected to the main wiring harness, as the electronic management functions of the speed sensors necessary for the vehicle control systems reside within this unit. After removing the brake lines connected to the ABS unit, the relative connector ports must be plugged with screws to prevent loss of the fluid contained in the unit itself.

4.3. WITH RACING BRAKE SYSTEM WITHOUT ABS ECU

In order to also remove the ABS ECU, a kit must be installed which allows the system to acquire the speed sensor signals. This kit includes a supplementary ECU (CLF), a wiring harness for connecting the CLF ECU to the main wiring harness, a mount and the relative fastener hardware for installation. This kit allows the vehicle system to acquire the speed sensor signals necessary for correct operation of the vehicle control systems, and also includes a mount for installing the supplementary ECU and the voltage regulator.

NOTE – When using this kit, the headlamp and horn must be removed to permit installation of the additional parts necessary.

The list of part numbers and description for ordering this kit are:

Code	Description	Q.
COT140199	ECU MOUNT, SST 2015	1
B043676	TONE WHEEL ACQUISITION ECU - CLF	1
COE14136	CLF CONNECTOR WIRING HARNESS	1
254485	M6 SPRING PLATE	6
CO8220150	RUBBER RING	2
AP8121728	T-SHAPED BUSHING	4
AP8152278	M6X16 HEX HEAD SCREW	2
AP8152280	M6X25 HEX HEAD SCREW	4
COVHIC4025	SHC SCREW M5X40	1
COVMTC0000	M5 ERGAL FLANGED NUT	1

The following operations are necessary to install this kit:

- Modify the plastic instrument cluster mount (photos 1 and 2)
- Install the fastener hardware on the instrument cluster and on the metal mount (photos 3 and 4)
- Fasten the CLF ECU and voltage regulator on the metal mount (photos 5 and 6)
Note: To install the AMP (Aprilia Multimedia Platform) ECU as well you must place it under the CLF, as illustrated in photos 17 and 18. To secure the two ECUs the CLF fixing screws (M6x16) must be replaced and the 2 threaded M6 clips must be removed, installing the screws and nuts indicated in image 18.
- Fasten the metal mount onto the instrument cluster mount (photos 7 and 8)
- Remove the lower plastic fork end piece (P/N 893113) from the motorcycle.
- Fit the instrument cluster mount on the motorcycle (photos 9 and 10)
- Install the supplementary CLF wiring harness, routing correctly as indicated (photo 11)
- Connect the supplementary wiring harness to the CLF (photo 12) and to the left hand vehicle wiring harness (photo 13).
*Note: if the AMP ECU is also installed you must be careful with the CLF connector because the connector for the 2 ECUs is identical!
Therefore connect the supplementary wiring harness to the CLF connector first. Then proceed with connecting the tail fairing (code 2S000580) to the AMP ECU and to the supplementary wiring harness. This tail fairing should be connected to the supplementary wiring harness in the "optional bluedash V4 MP" connector of the short section of the wiring harness (see photos 11 and 18).*
- Connect the front speed sensor (photo 14) and the rear speed sensor (photo 15) to the supplementary wiring harness.
- Bridge pins 10 and 17 (photo 16) on the ABS ECU connector to disable ECU diagnosis (and prevent activation of the alarm warning lamp on the instrument cluster). Insulate and cover the connector with insulating tape .
The step is optional. However, if it is not performed, the ABS warning lamp will remain permanently lit on the instrument cluster.

Photos 1 and 2

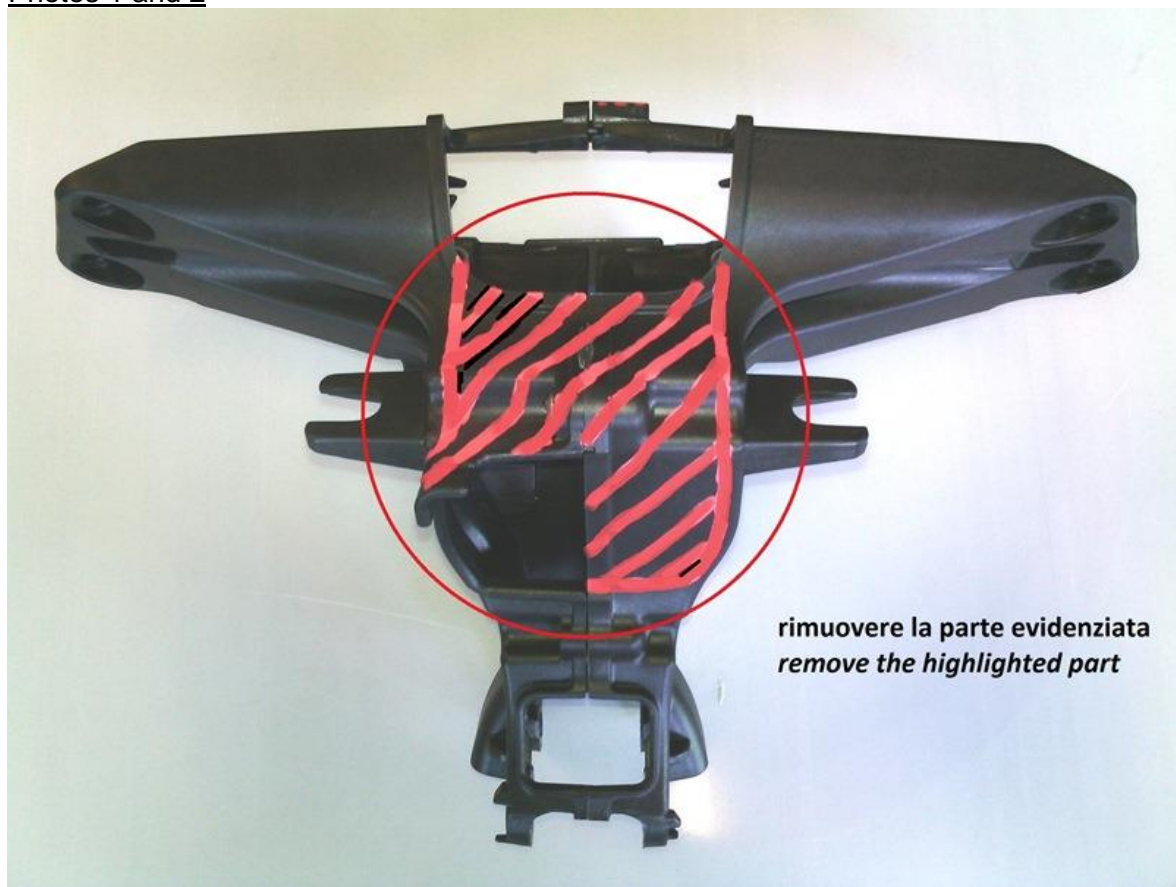

Photos 3 and 4

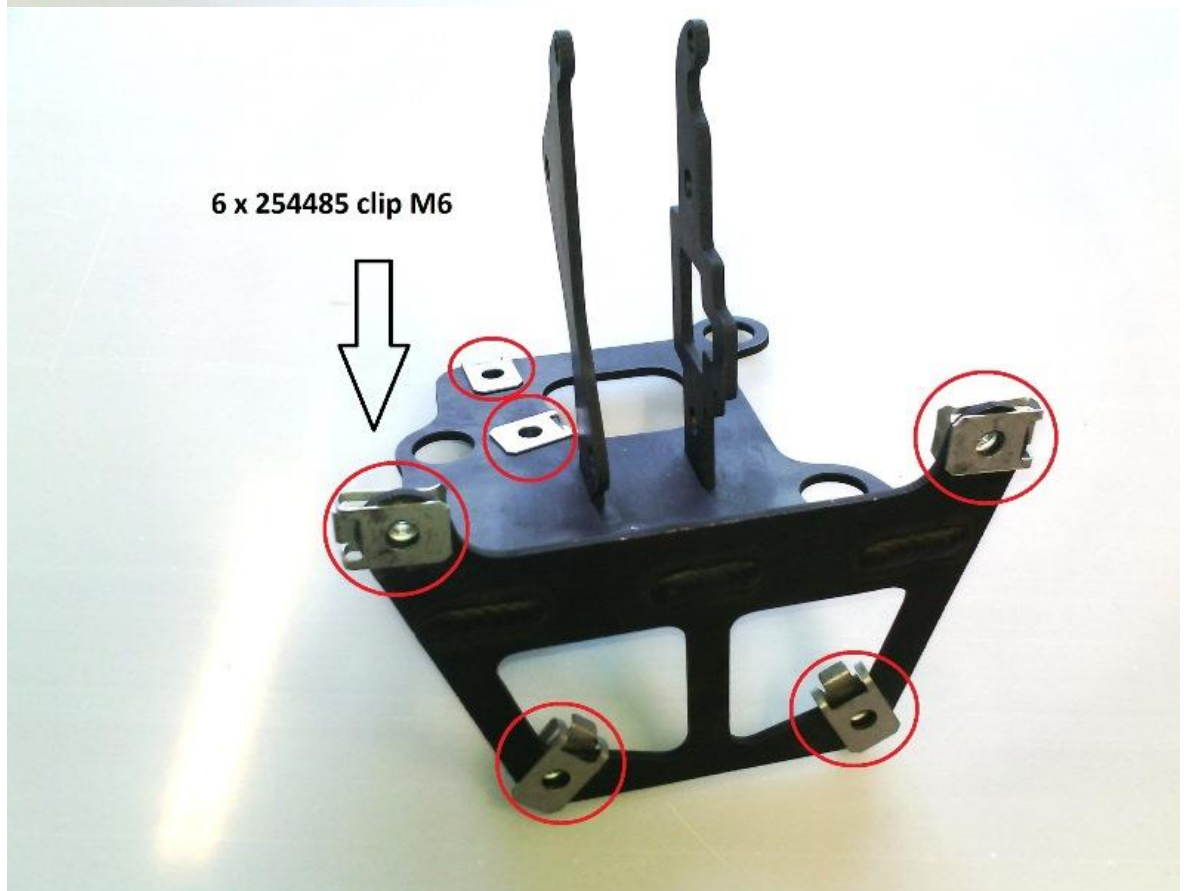

Photos 5 and 6

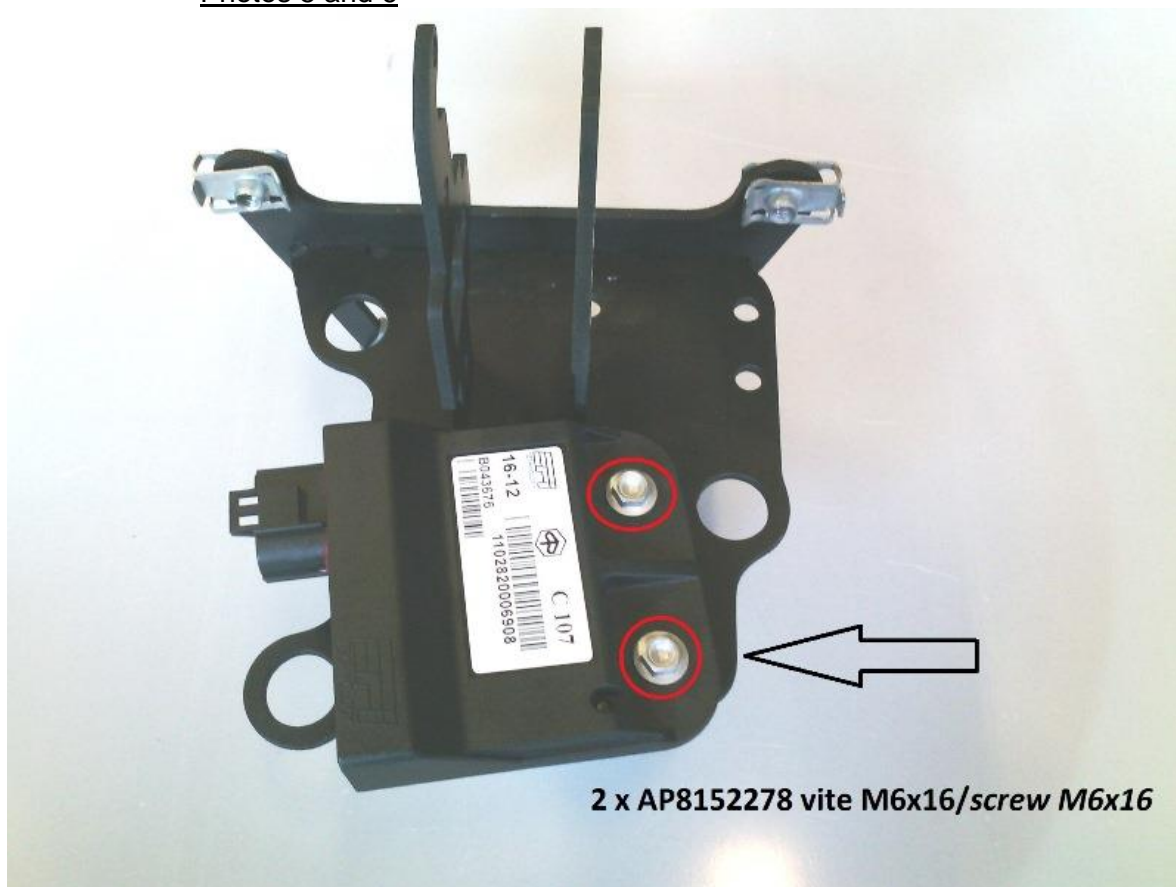

2 x AP8152278 vite M6x16/screw M6x16

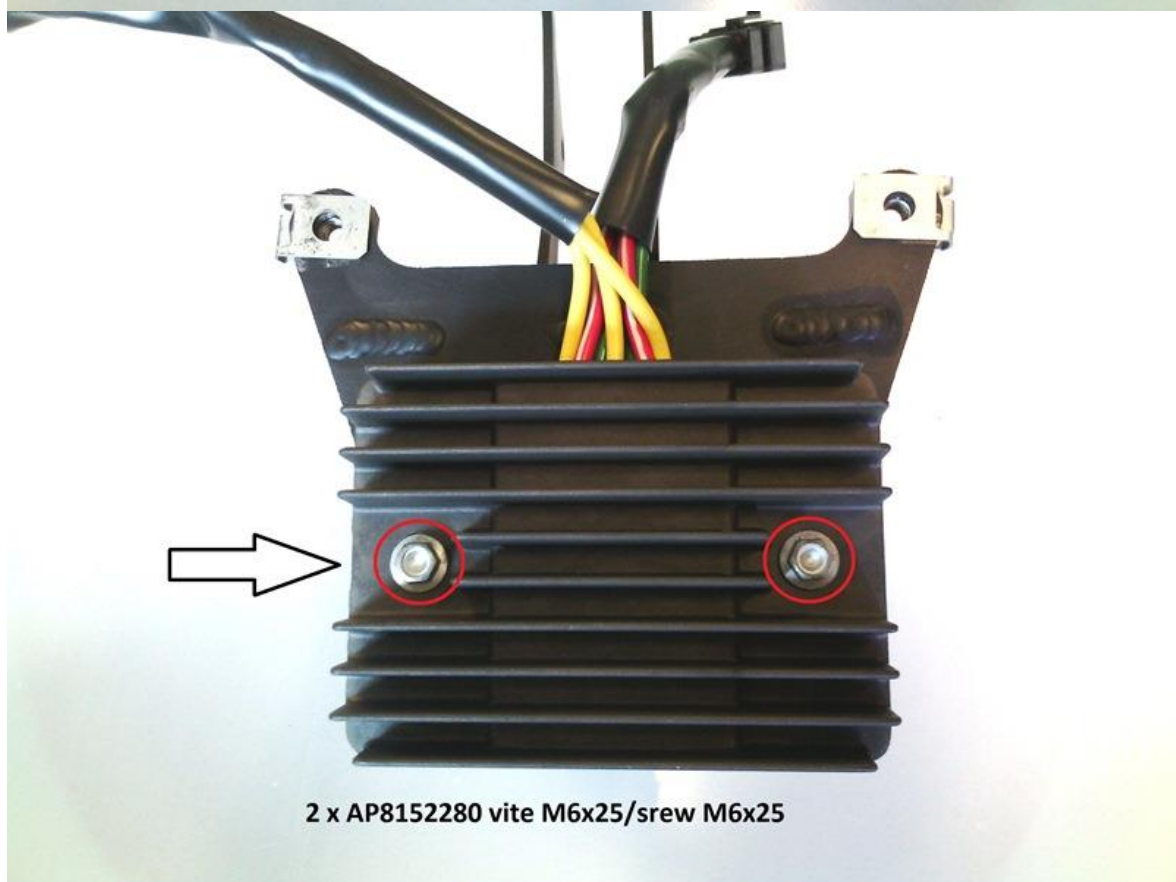

2 x AP8152280 vite M6x25/screw M6x25

Photos 7 and 8

1 x COVHIC4025 vite M5x40/screw M5x40
1 x COVMTC0000 dado M5/M5 nut

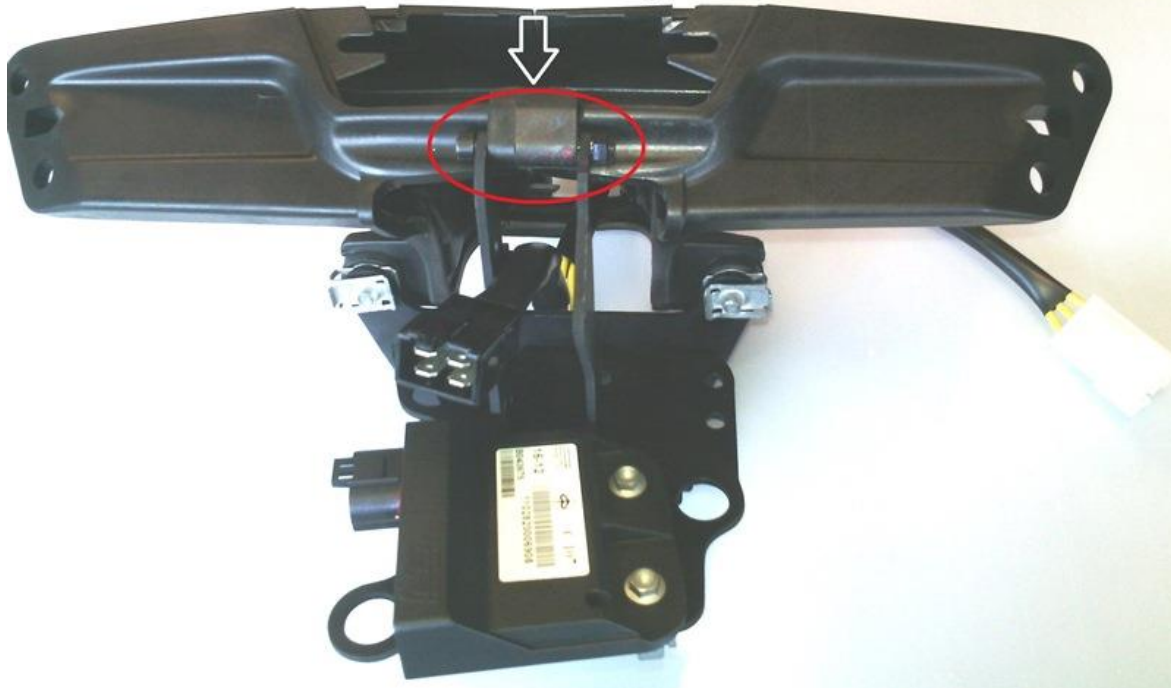

2 x AP8152280 vite M6x25/screw M6x25



Photos 9 and 10



Photos 11 and 12

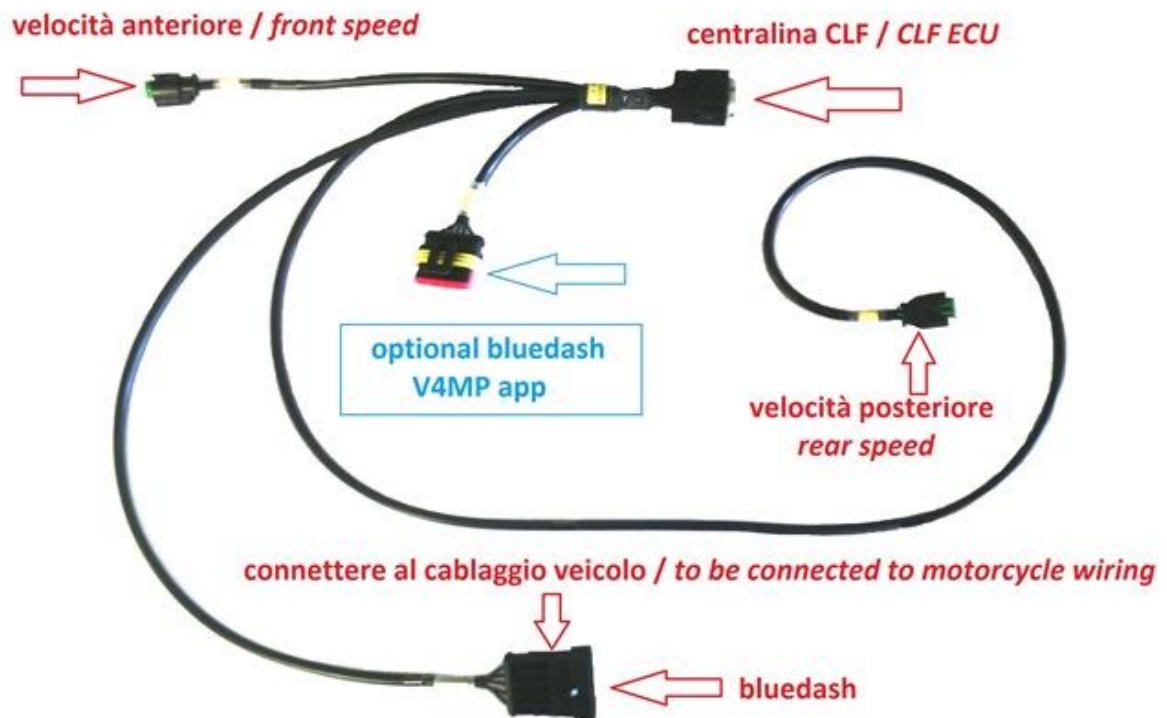

Photos 13 and 14

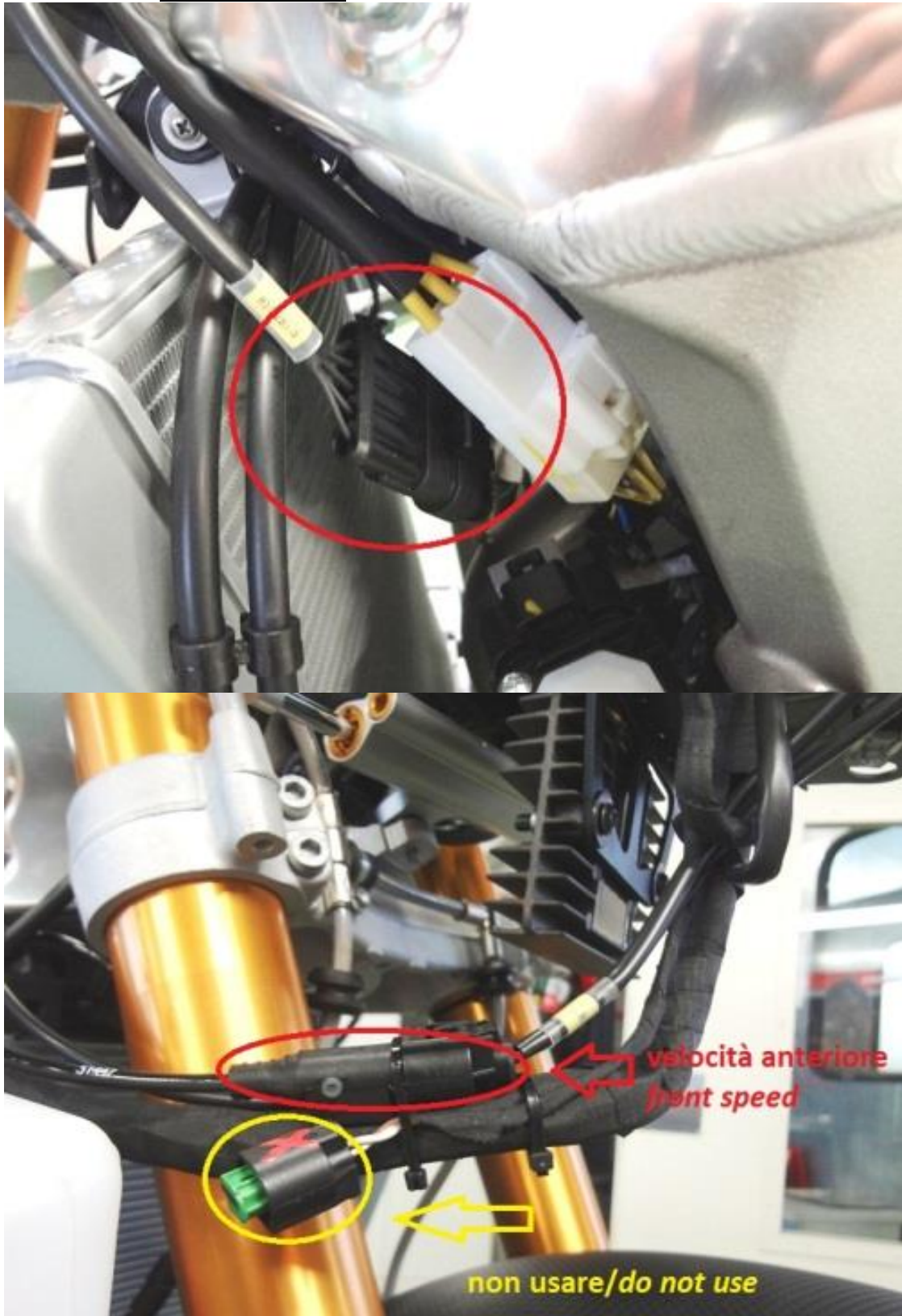

Photos 15 and 16

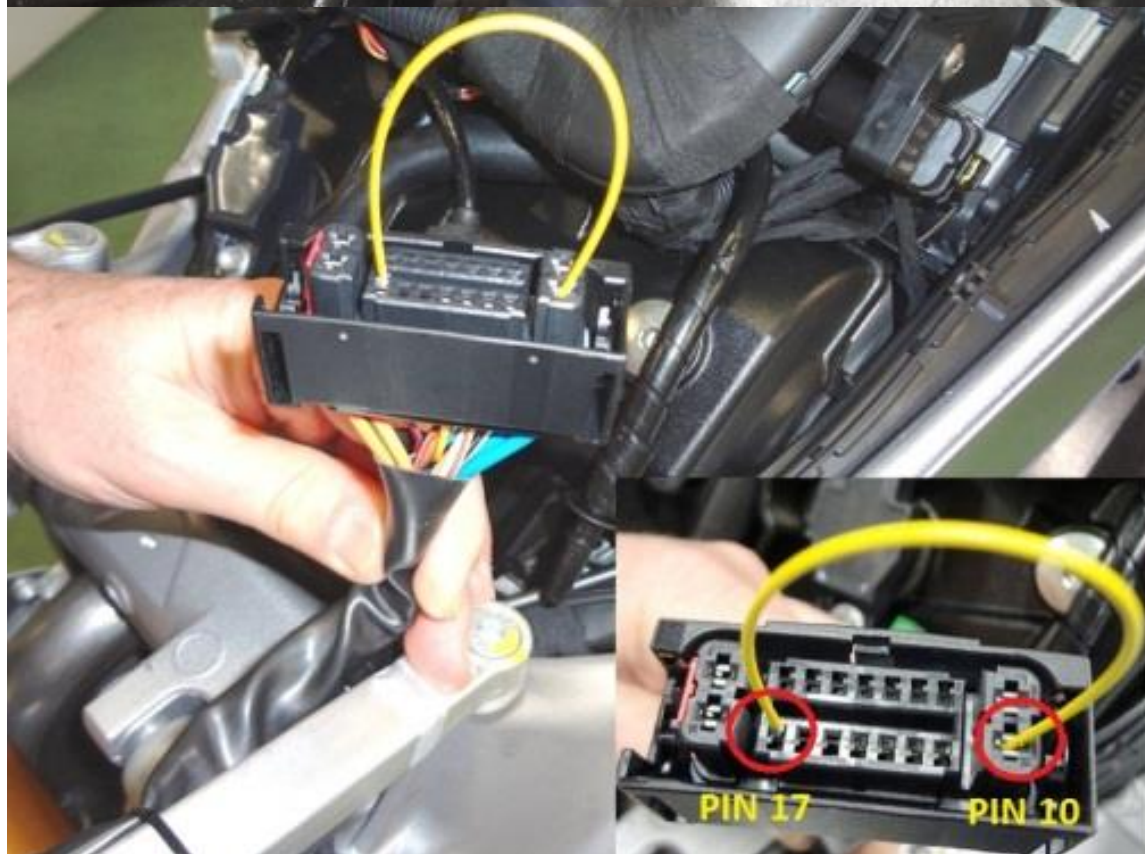
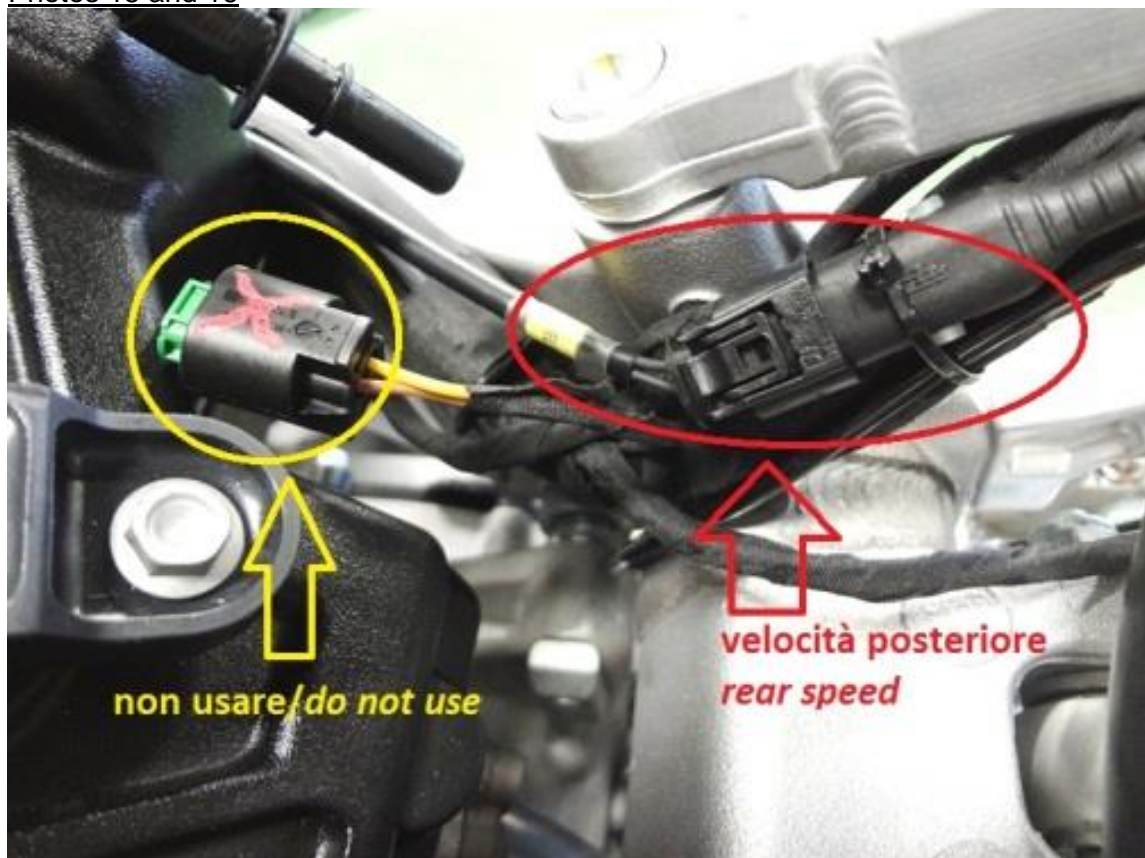

Photos 17 and 18



COMPLETE LIST OF PART NUMBERS DESCRIBED IN THIS MANUAL

Code	Description	Q.	order
COE15059	MARELLI RACING ECU, RSV4 RR/LE MY2015	1	
COE15070	RSV4 MY2015 INSTRUMENT CLUSTER, NO IMMO	1	
COE15062	CIRCUIT POWER SWITCH	1	
COE15001	SIDE STAND RETRACTED CONNECTOR	1	

Kit of components for removing ABS

Code	Description	Q.	order
COT140199	ECU MOUNT, SST 2015	1	
B043676	TONE WHEEL ACQUISITION ECU - CLF	1	
COE14136	CLF CONNECTOR WIRING HARNESS	1	
254485	M6 SPRING PLATE	6	
CO8220150	RUBBER RING	2	
AP8121728	T-SHAPED BUSHING	4	
AP8152278	M6X16 HEX HEAD SCREW	2	
AP8152280	M6X25 HEX HEAD SCREW	4	
COVHIC4025	SHC SCREW M5X40	1	
COVMTC0000	M5 ERGAL FLANGED NUT	1	

Aprilia Racing S.r.l.

Sede operativa:

Via G. Marconi 9

30033 Noale (VE) Italy

Info and technical support: racing_support@aprilia.it

Website: <http://www.serviceaprilia.com/public/racing/index.asp>