

## F12A101R20 - fork kit F12R - APRILIA RS125SP (type Marzocchi - radial brake caliper)

### FORK KIT PARTS

- A- Inner tube Ø 40      B- Cartridge Ø 20  
C- Fork cap              D- Top Spacer  
E- Spring kasher + Spring bush set      F- Spring kit  
G- Spring washer              H- Screw M10  
Motorex Fork Oil SAE 5 W (1l)

### ASSEMBLY INSTRUCTIONS

- Remove the original OEM FORK KIT and INNER TUBE from the bottom fork, warming the surface of the bottom. NOTE. The bottom is fitted by pressing.
- Thoroughly clean sleeve, fork tube and bottom avoiding all damages to oil retainers and guide bushings (clean the glue residual).
- Fit the inner tube "A" (included in the kit) on bottom and make sure it is in axle perfectly. Reassemble bushings and oil retainer on the sleeve and add grease to all sliding parts
- Position the fork kit "B" inside the fork tube "A". Make sure it is firmly on its bottom base.
- Tighten the lower screw "I" (photo 1) (already tightened from the house, 30N) and make sure the fork kit lines up perfectly inside the fork tube, otherwise the kit is not properly positioned. In this case carefully repeat last step.

### AIR BLEEDING INSTRUCTIONS

- Slowly pour oil into the fork so that it flows inside the cartridge. Slide rod up and down several times to bleed any air bubbles out of the cartridge
- Adjust oil level according to the instructions of the setup card.  
**Note:** Oil level must be measured without spring and the rod pushed completely down.
- Position the Fork Kit Parts as following:
  - "G" spring washer
  - "F" spring kit
  - "E" Spring kasher + Spring bush set
  - "D" Top spacer
- Position the rod to the maximum extension
- Position the fork cap "B".  
**Note:** tighten the pumping rod on the fork cap. Torque load 20N
- Screw the fork cap onto the sleeve, make sure you do not damage the O-ring placet under the fork cap. Torque load 5N

### Note:

- Fork **RIGHT** = **COMPRESSION** adjustment
- Fork **LEFT** = **REBOUND** adjustment

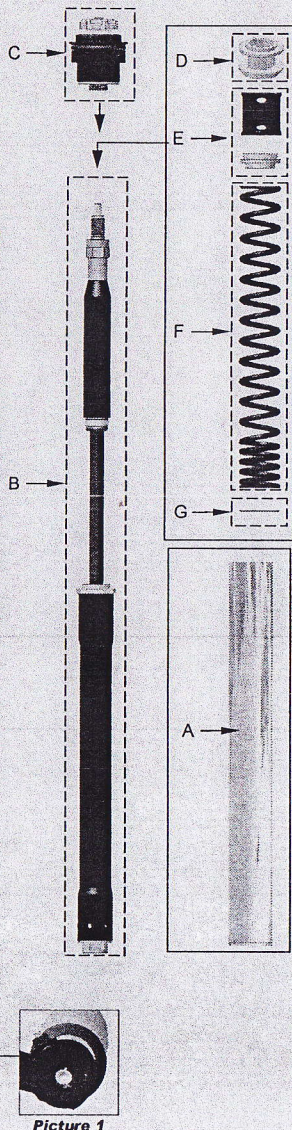

Picture 1

## F12A101R20 - fork kit F12R - APRILIA RS125SP (type Marzocchi - radial brake caliper)

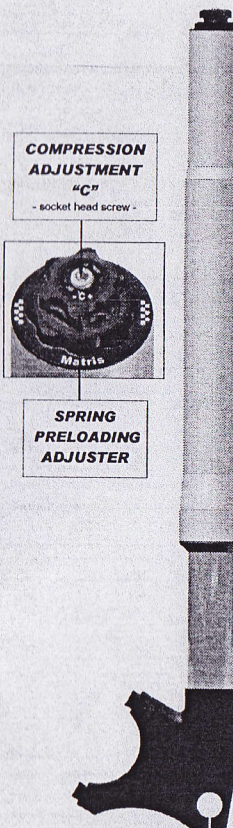
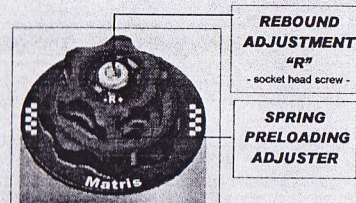

RECOMMENDED ADJUSTMENT SETUP				
Rebound adjustment	20 Click			
Compression adjustment	20 Click			
Spring constant reference	SX	5.5	DX	5.5
Spring preload	12 Click (2 click = 1 mm)			
Oil level mm	120 mm			
Stroke mm	125 mm			
Heigh from top plate mm				

### NOTE:

- Fit the fork tube with compression adj. on the right side (support brake side) and the fork tube with rebound adj. on left side.
- Matris fork length = 700mm

ADJUSTMENT STEP 2				
Rebound adjustment	Click			
Compression adjustment	Click			
Spring constant reference	SX		DX	
Spring preload	Click			
Oil level mm				
Stroke mm				
Heigh from top plate mm				

**COMPRESSION & REBOUND adjustment**  
To count the rebound and compression clicks: from fully closed, turn anticlockwise

**SPRING PRELOAD adjustment**  
from fully open, turn clockwise  
2 clicks = 1 mm

During assembling and fitting the fork kit, to avoid damage to the fork components, make all adjustments with the fork kit mounted on the fork. Not act on the adjustments when the fork caps or cartridges are disassembled.  
Make sure that the settings are in the full open position (Compression & Rebound) and full unloading (Spring Preload). The fork kit is supplied with all adjustments to "zero". All adjustments must be made with all components fitted on the fork.

ENG



**ATTENTION**  
To remove the fork and tightening torques, follow the service manual



# KIT FORK

## ! WARNINGS !

The installation must be performed according to manufacturer's instructions.

 The use of oil other than the one recommended by the manufacturer may compromise the functioning of the entire Kit.

This product shall be destined for the use and for the model of motorbike for which it was expressly built.

The company accepts no responsibility for injuries or property damage to persons, animals or objects caused by incorrect installation, usage of non original parts and modifications made on the Fork Kit and/or on its components.

Interventions and modifications not authorized by the manufacturing company may jeopardize the safety of the user.

## ! NOTES !

All adjustments, especially those requiring the use of keys, must be performed carefully and without exerting excessive force.

The fork cap must be tighten without exerting excessive force.

We recommended to fasten the screws of the fork upper/lower plates (with proper dynamometric key) and at the same time to respect the tightening torque as indicated by the vehicle manufacturing company.

Possible modifications of hydraulic adjustments of the lamellar packs must be expressly authorized by the Fork Kit manufacturer.

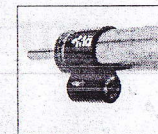
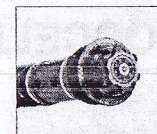

## ! WARRANTY !

The products are covered by a *twelve (12) month* warranty which is strictly limited to repair or replacement of defective components at the company's unquestionable decision.

### The Warranty Excludes:

- Any type of intervention carried out by organizations different from authorized *Matris* Service Centers (i.e., rigging, technical/structural modifications, etc.) on shock-absorbers while under warranty.
- All parts not manufactured by *Matris* (washers, bushings, screws, etc.).
- All components subject to wear and tear (oil seals, DU bushings, O-rings, etc.).

### The warranty does not apply to damages caused by:

- Faulty installations.
- Transport or incautions handling.
- Failure to follow maintenance and handling instructions.

The Warranty becomes null and void if the items are damaged or rendered inoperable through tampering or if non original spare parts have been used.

*Matris* reserves the right to thoroughly examine the items under warranty that are the object of claims by having customers to send them at their own risk and expenses.

In case of issues that can be easily resolved by unskilled technicians, the *Matris* Company's intervention will be limited to solely supply pertinent instructions.

**Matris may change its products at any time at its sole discreption and without prior notice.**

## ! RESPONSABILITY !

The purchaser of any *Matris* product will free the manufacturer and expressly the *Matris* Company from all liabilities and responsibilities in connection with the use of the products.

Before driving your vehicle make sure that the product works properly and that is installed and adjusted correctly so as not to jeopardize your safety.

Do not wash the product with liquis sprayed at high pressure.

Frequent and correct ordinary maintenance will preserve the product for a long time.

### Follow thoroughly the instructions and warnings set forth herein.

**Do not jeopardize your driving safety by allowing unskilled, non-authorized personnel to make changes or do maintenance on your product and be aware that *Matris* will Disclaim all responsibilities due to failure to comply with this provision.**

## ! SERVICE & REPAIRS !

All technical interventions constituting ordinary and extraordinary maintenance of the product must be performed by a *Matris* Authorized Service Center.

Whenever is necessari to check and/or rig the safety standards of the product, the dealer shall inform the customer about the nearest *Matris* Authorized Service Center.

 The safety standards of this product shall not be changed and it is forbidden to make any modifications to the product or parts of it.

All product maintenance and repair services must be strictly and solely performed by *Matris* Authorized Service Center personnel in compliance with the instructions and information herein contained.