

OVERVIEW

The SR/S Top Box Rack Assembly (p/n 10-08280) was designed by Zero Motorcycles to augment the utility of your Zero SR/S. The rack is manufactured using black powder-coated steel.

The SR/S Top Rack and SHAD SH39 Top Case Kit (p/n 10-08281) includes the top rack assembly, a SHAD SH39 top case, the SHAD adapter plate and all necessary hardware for installation.

Lockable, easily removable and aerodynamic, the SHAD SH39 top case offers convenient storage in a central location. Positioned behind the rider or possible passenger, the top case does not widen your motorcycle and sits in the rider's slipstream. With 39 liters of capacity and a maximum load of 8.8lbs (4kg), the top case is large enough to hold a helmet and many other goods simultaneously.

Install Time: Approx. 30 minutes (45 minutes with top case).



Item 1. SR/S Top Rack Assembly



Item 2. SR/S Top Rack and SHAD Top Case

REQUIRED TOOLS AND PARTS

SPECIAL TOOLS REQUIRED

- None

PARTS REQUIRED

SR/S Top Rack Assembly (p/n 10-08280) includes:

ITEM	PART NUMBER	QTY	ITEM NAME
1	24-08608	1	Seat Tray Rack
2	26-08370	1	Top Rack Plate
3	26-08450	1	Tail Frame Z Plate
4	46-08246	1m	Weather Seal Black Rubber Double "D" 7.9MM X 9.1MM 1025
5	81-08087	12 in.	Foam Strip, 1/8" thick x 3/4" wide, Adhesive Back
6	90-02103	2	Washer Size 6
7	91-08164	4	Hex Head Flange Bolt Star Drive M6X20 10.9
8	90-08264	4	Star Drive Button Head Screw M6x25 8.8

SR/S Top Rack and SHAD Top Case Kit (p/n 10-08281) additionally includes:

ITEM	PART NUMBER	QTY	ITEM NAME
9	24-08481	1	Top Case With Adapter Plate, SHAD SH39

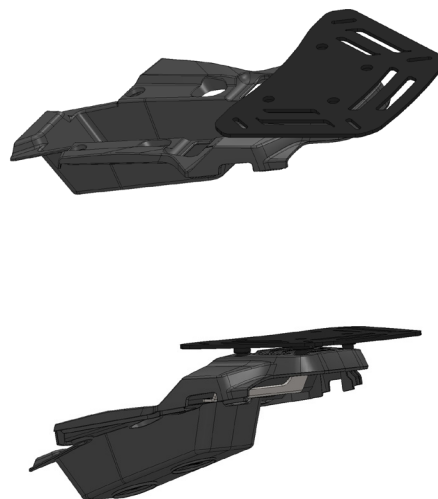

Item 3. SR/S Top Rack Assembly

INSTALLATION INSTRUCTIONS

1. Confirm that you have all parts before starting the installation. If any parts are missing, please contact the Zero Motorcycles Aftersales Team with your order number and the missing items will be sent promptly.
2. Remove the passenger seat by unlocking with key and pulling up and forward.
3. Using a T25 and a T30 Torx bit socket and ratchet, remove the six bolts that secure the existing seat tray. Retain the two black M5 x 12 shoulder bolts for later use. See Figure 1.
4. Remove both of the grab handle bolts M6x25 near the end of the tail pod. Retain these bolts for later use. See Figure 2.
5. Place the Tail Frame Z Plate (Item 3) on the grab handle and rack end as shown in Figure 3. Note the orientation of the Tail Frame Z Plate as the flange that lays on the grab handle has a larger surface area.
6. Secure the Z Plate on top of the grab handle using the saved grab handle bolts and the two Washers Size 6 (Item 6), and then two of the Star Drive Button Head Screw M6x25 (Item 8).
7. Torque the grab handle bolts to 10 ft-lbs (14 Nm). Then remove the button head screws on the top of the Z plate. They were used to hold the Z plate in place during this initial torquing of the lower bolts, and will be used to secure the Seat Tray Rack in the next step. See Figure 4.

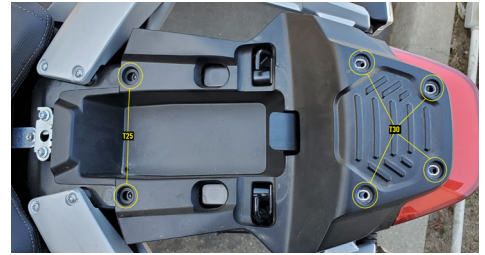

Figure 1. Seat Tray Bolt Locations



Figure 2. Grab Handle Bolt Locations

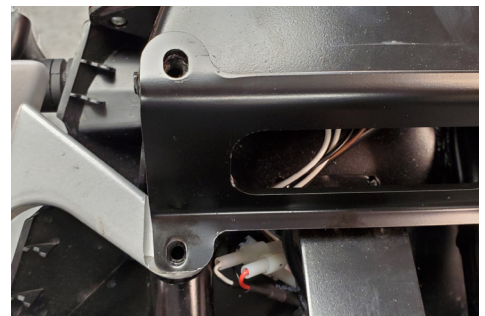

Figure 3. Tail Frame Z Plate Placement and Orientation



Figure 4. Tail Frame Z Plate In Place

INSTALLATION INSTRUCTIONS (CONT'D)

8. Install the Seat Tray Rack (Item 1) with the retained black M5 x 12 shoulder bolts. See Figure 5.
9. Secure the Top Rack Plate (Item 2) to the Seat Tray Rack with the four M6x25 Star Drive Button Head Screws (Item 8). Torque to 10 ft-lbs (14 Nm).
10. Reinstall passenger seat.

Continue only if also installing the Top Case With Adapter Plate, SHAD SH39 (Item 9). If you are only installing the top box rack assembly you will have extra parts.

11. Mount the SHAD adapter plate using the lock nuts, washers and brackets supplied with the SHAD Top Case (Item 9) and the four Hex Head Flange Bolt Star Drive M6X20 10.9 (Item 7). Bolts will be positioned pointing upward. Tighten only to hand tight. See Figures 6, 7 and 8.
12. Center the SHAD adapter plate on the Top Rack Assembly metal top plate. Then, fully tighten the lock nuts to secure the adapter plate.



Figure 5. Seat Tray Rack Installed

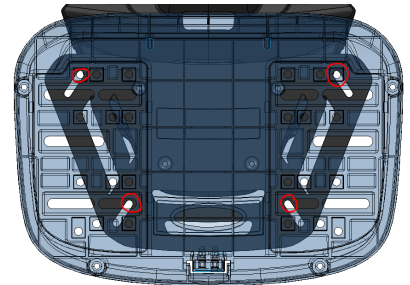

Figure 6. SHAD Adapter Plate Bolt Locations



Figure 7. Securing SHAD Adapter Plate (from below)



Figure 8. Securing SHAD Adapter Plate (from above)

INSTALLATION INSTRUCTIONS (CONT'D)

13. Insert covers into SHAD adapter plate. See Figure 9.
14. To ensure a more silent ride and limit any rattling of the top case, two 0.15 meter lengths of the Foam Strip, 1/8" thick x 3/4" wide, Adhesive Back (Item 5) can be installed along the cover plates. See Figure 10.
15. The Weather Seal Black Rubber Double "D" 7.9MM X 9.1MM 1025 (Item 8) should be installed along the edge of the SHAD SH39 top case. See Figure 11.
16. Snap the SHAD SH39 Top Case into place per the instructions provided by SHAD to complete the installation.



Figure 9. Left Cover Inserted



Figure 10. Foam Strip Placement For Silent Ride



Figure 11. Weather Seal Installed On Case